

Metal Bellow Coupling

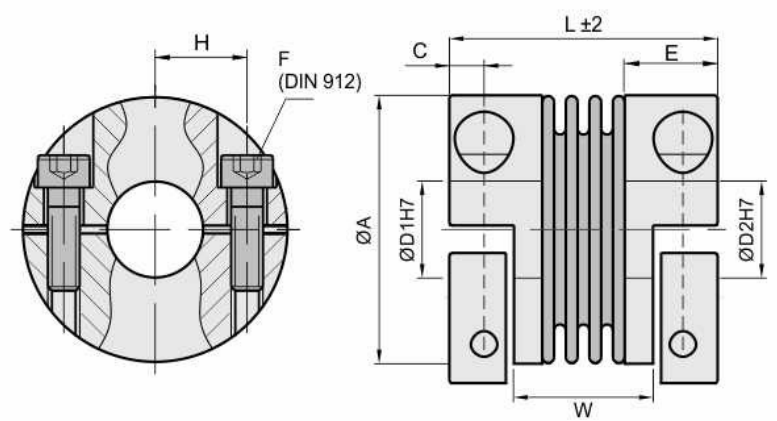

Split Hubs Clamping



	DIMENSIONS (mm)								TECHNICAL DATA									
	Rated Torque TKN (Nm)	Length (±2) L	Outer Ø A	Bore Range min~max D1 / D2	Bolt Center Distance		Hub Length E	W	Screw (DIN 912) TA (Nm) F	Mass (kg)	Moment of Inertia J (g m ²)	Spring Stiffness			Misalignment			max Speed rpm
					H	C						torsional CT 10 ³ xNm/rad	radial CR (N/mm)	axial CA (N/mm)	radial DKr (mm)	axial DKa (mm)	angular DKw (°)	
ONX4H/18	18	63	45	10~25	17	5.5	19.5	37	M5	0.10	0.04	20	205	50	0.2	0.5	1.5	10000
		71						45	8	0.15	0.05	15	82	36	0.25	1	2	10000
ONX4H/30	30	70	56	10~30	20	7.5	27	36	M6	0.32	0.15	38	720	50	0.15	0.6	1.5	10000
		78						44	15	0.34	0.16	28	225	28	0.25	1	2	10000
ONX4H/60	60	83	66	12~35	23	10	31	38	M8	0.55	0.33	75	1150	90	0.15	0.6	1.5	8700
		93						49	40	0.65	0.36	50	340	50	0.25	1	2	8700
ONX4H/80	80	96	82	14~42	28	10.5	36	49	M10	0.90	2.0	128	1200	80	0.2	0.5	1.5	6900
		108						61	72	0.95	2.1	75	400	50	0.25	0.8	2	6900
ONX4H/150	150	96	82	18~42	28	10.5	36	49	M10	0.90	2.0	155	2020	145	0.2	0.5	1.5	6900
		108						61	84	0.95	2.1	105	595	85	0.25	0.5	2	6900
ONX4H/200	200	106	90	22~45	31	13	41	50	M12	1.30	3.3	175	2500	145	0.2	0.5	1.5	6400
		119						63	125	1.35	3.5	120	460	82	0.25	0.8	2	6400
ONX4H/300	300	115	110	25~60	39	13	43	58	M12	1.80	7.3	502	6300	280	0.2	0.5	1.5	6000
		126						69	145	1.85	7.5	285	1400	145	0.25	0.8	2	6000
ONX4H/500	500	131	122	30~65	42	15	51	67	M12	2.50	12.4	690	7790	100	0.2	0.5	1.5	5000
		142						78	145	2.53	12.7	320	970	85	0.25	1	2	5000

ORDER CODE EXAMPLE

ONX 4H/60	-	83	-	15	-	20	-	H7
Type / Size		Length (L)		Bore (ØD1)		Bore (ØD2)		Bore Tolerance

Material (Standard):
Bellow - Stainless Steel
Hubs - Aluminium

Speeds:
Standard upto 10,000 rpm,
above 10,000 available with finely
balanced against order.

Temperature Range:
-30° to +120°C (3.6F - 250F)

Dimension : unit(mm)